



## A-Frame Easel No. 1

# Guide to Assembly

Congratulations on purchasing the SoHo Urban Artist A-Frame Easel - Made from solid finished wood with brass fitting hardware, the SoHo A-Frame Easel is designed to stand the test of time. Measuring 26" wide by 30" deep by 96" high, it can easily accommodate canvases up to 53" high, and has a forward-tilting mast to reduce glare or for pastel art. Perhaps the best part is its versatility: the SoHo A-Frame Easel folds flat for storage or transport in just seconds, and sets back up just as fast!

**Carefully read through all instructions before proceeding. Helpful videos are available online. See reverse.**



# Parts & Hardware

*Carefully check the contents of the box to ensure no parts are missing.*

- |  |                                    |
|--|------------------------------------|
| <b>A</b> Allen Wrench × 1                    | <b>K</b> Center Mast Support Bar   |
| <b>B</b> ¾" Wood Screws × 2                  | <b>L</b> "U" Support Bar           |
| <b>C</b> ⅜" Wood Screws × 3                  | <b>M</b> Black Turn Knobs × 2      |
| <b>D</b> 2" Bolts, Springs & Barrel Nuts × 2 | <b>N</b> Front Canvas Shelf        |
| <b>E</b> 4" Bolt, Washer & Wingnut × 1       | <b>O</b> Top Easel Support Bar     |
| <b>F</b> 4.5" Bolt & Barrel Nut × 1          | <b>P</b> Bottom Easel Support Bar  |
| <b>G</b> 3" Bolts & Barrel Nuts × 4          | <b>Q</b> Back Center Mast          |
| <b>H</b> Ratchet System with ¾" screws × 1   | <b>R</b> Center Leg Support        |
| <b>I</b> Brass Plates × 2                    | <b>S</b> Right & Left Support Legs |
| <b>J</b> Top Canvas Support × 1              | <b>T</b> Front Center Mast         |

*Be sure to read through and understand all instructions before proceeding.*



Screwdriver Included

**N**



**A**

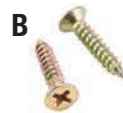

**B**



**C**



**D**



**E**



**F**



**G**



**H**

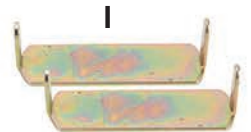

**I**



**J**



**K**



**L**



**M**



**O**



**P**



**Q**



**R**



**S**



**T**

# Assembly Instructions

## STEP 1

Parts Needed: **A, F, H, N, T, Screwdriver**

First, connect the front center mast (T) to the front canvas shelf (N) using the 4.5" bolt and barrel nut (F) tighten using the Allen wrench (A). Next, secure the ratchet system (H) to the bottom of the canvas shelf (N).

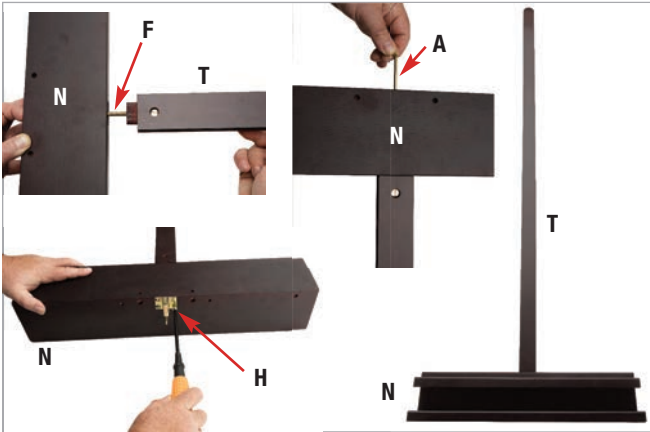

## STEP 2

Parts Needed: **Screwdriver, I, K, O, B**

Attach the top easel support bar (O) to the center mast support bar (K) using the 3/4" wood screws (B). Next, secure the brass plate (I) to the center mast support bar (K).

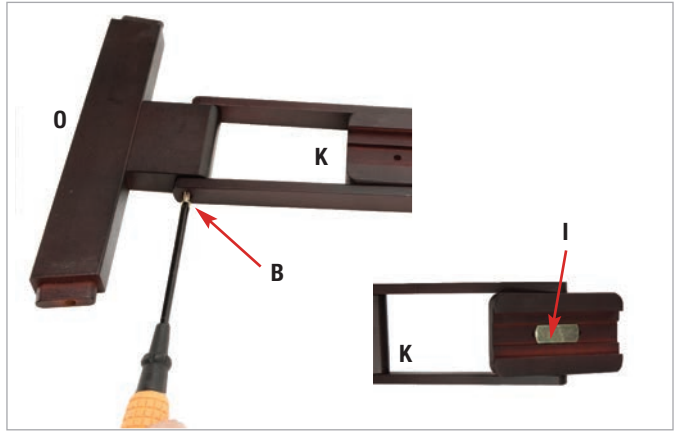

## STEP 3

Parts Needed: **Screwdriver, C, R, Q, E**

Connect the back center mast (Q) to the center leg support (R) using the 3/8" wood screws (C). Next, connect the small support arms through the 3" long slot in the center leg support (R) using the 3" bolt and wing nut (E).

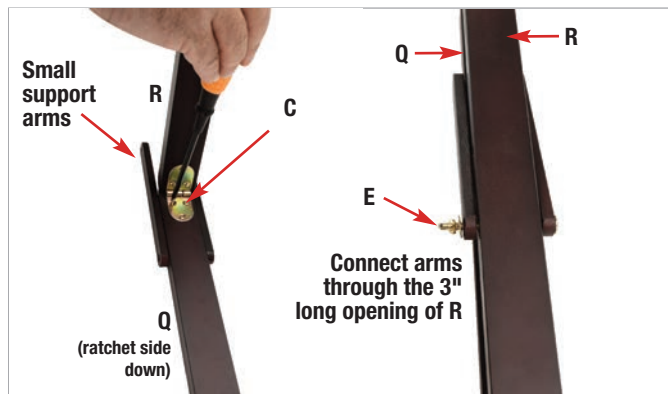

## STEP 4

Parts Needed: **A, G, O, P, S, K, Q, T**

Begin by placing back center mast (Q) between top and bottom center supports (O) and (P). Then join (O) and (P) to right and left support legs (S) using the 3" bolts and barrel nuts (G). Lay the easel flat on its backside and slide the front center mast (T) into the center mast support (K), from the bottom up. Ensure that brass plate is still in place before sliding the mast up.

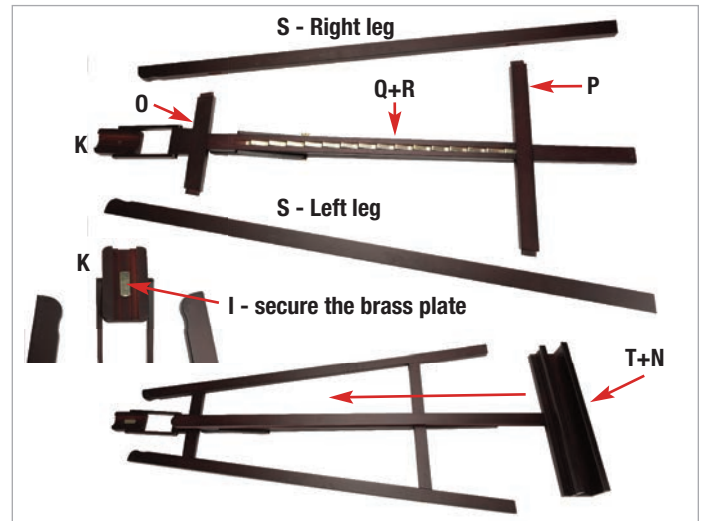

## STEP 5

Parts Needed: **A, D, L, N, Q, P**

Turn the easel upside down, then slide the springs onto the 2" bolts (D). These go into the "U" support bar (L). Attach the "U" support bar (L) to the back of the front canvas shelf (N). Note that the back center mast (Q) will pass through the "U" support bar (L). Please note, due to the use of springs, use pressure to secure the 2" bolts to the barrel nuts using the Allen wrench (A).

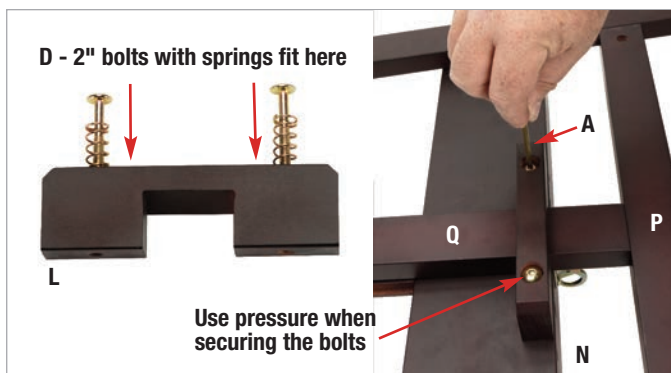

## STEP 6

Parts Needed: **I, J, M, T, K**

Add a brass plate (I) to the back of the top canvas support (J). Then slide the top canvas support (J) onto the front center mast (T) from the top down, keeping the brass plate (I) secure. Next, secure with a black turn knob (M). Finally, secure the center mast support (K) with a black turn knob (M).

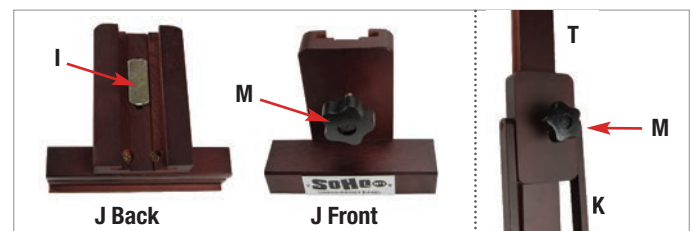



# SOHO™

URBAN ARTIST EASEL

**Versatile Easels at Affordable Prices!**

**Furniture Quality  
Construction**

**Elegant Mahogany  
Stain Finish**

**Made Of  
Solid Wood**

A-Frame No. 1

H-Frame No. 2

**Visit Jerry's Artarama for all your art supply needs!**



*Instructional videos for the SoHo Easels  
are available on our website.*

**SOHO EASELS**



*Search at [JerrysArtarama.com](https://www.JerrysArtarama.com)*